

Cable Plan

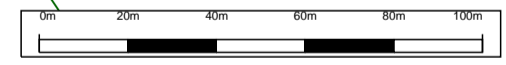
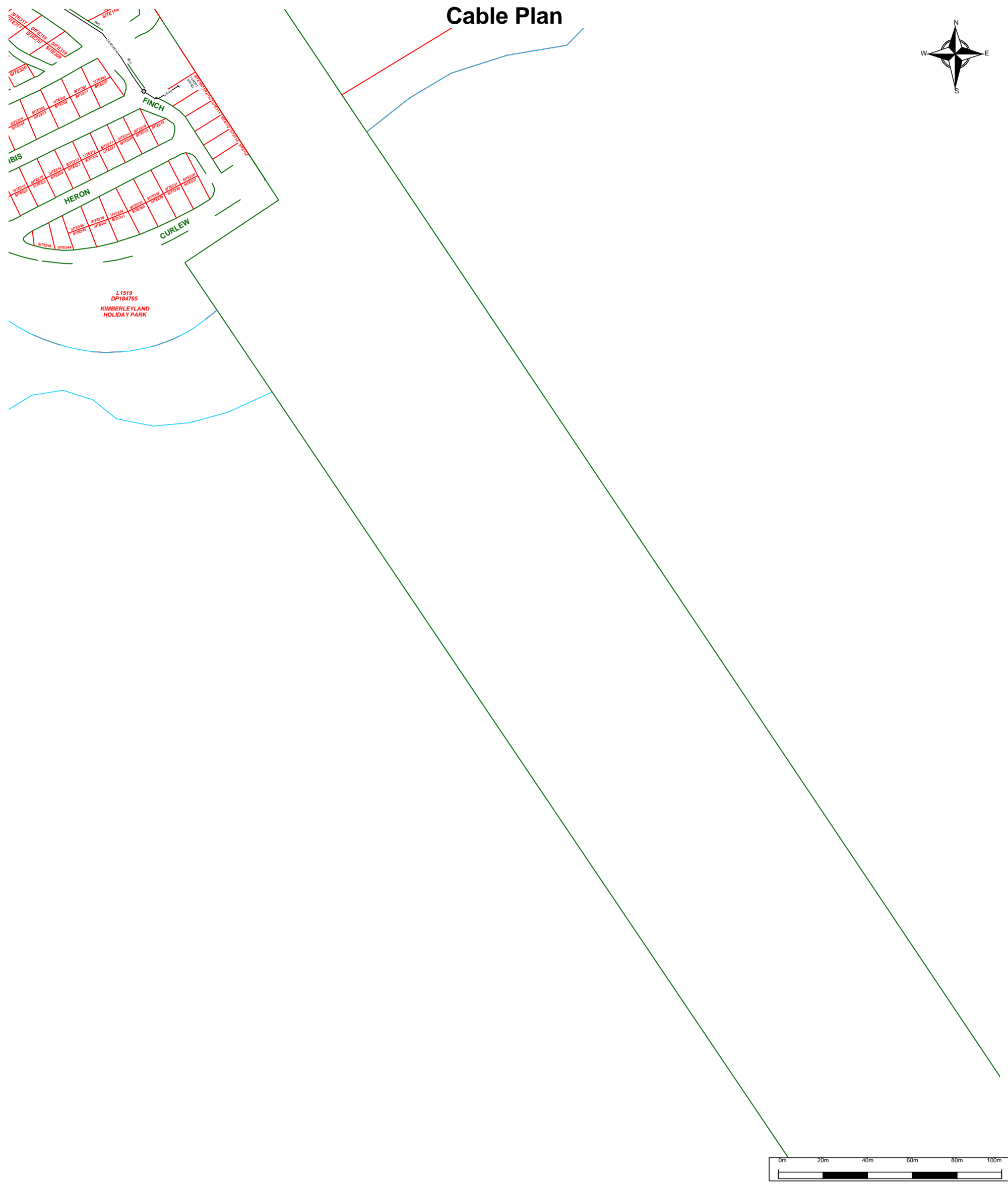

For all Telstra DBYD plan enquiries -
 email - Telstra.Plans@team.telstra.com
 For urgent onsite contact only - ph 1800 653 935 (bus hrs)

Sequence Number: 60234939
 Please read Duty of Care prior to any excavating

TELSTRA CORPORATION LIMITED A.C.N. 051 775 556

Generated On 06/04/2017 11:09:23

WARNING - Due to the nature of Telstra underground plant and the age of some cables and records, it is impossible to ascertain the precise location of all Telstra plant from Telstra's plans. The accuracy and/or completeness of the information supplied can not be guaranteed as property boundaries, depths and other natural landscape features may change over time, and accordingly the plans are indicative only. Telstra does not warrant or hold out that its plans are accurate and accepts no responsibility for any inaccuracy shown on the plans.

It is your responsibility to locate Telstra's underground plant by careful hand pot-holing prior to any excavation in the vicinity and to exercise due care during that excavation.

Please read and understand the information supplied in the duty of care statement attached with the Telstra plans. **TELSTRA WILL SEEK COMPENSATION FOR LOSS CAUSED BY DAMAGE TO ITS PLANT.**

Telstra plans and information supplied are valid for 60 days from the date of issue. If this timeframe has elapsed, please reapply for plans.