



Office Use Only

TRIM: _____

Grant No: _____

Project Coordinator: _____

CSRFF Small Grants Application Form

For projects up to \$200,000 to be acquitted by 15 June 2019

You **MUST** discuss your project with an officer from your nearest Department of Local Government, Sport and Cultural Industries office before completing and submitting your application. Failure to do so will render your project ineligible.

All applications **MUST** be submitted to your local government. Contact your local government to determine the cut-off date for the submission of applications.

DLGSC Contact:

Date:

Office:

Applicant's Details:

Organisation Name: East Kimberley Cricket Association

Postal Address: PO Box 1656

Suburb: Kununurra

State:

WA

Postcode:

6743

Street Address:

Suburb:

State:

Postcode:

Preferred Contact Person:

All application correspondence will be directed to this person

Name: Matthew Fletcher

Title: Dr ☐ Mr ☒ Mrs ☐ Ms ☐

Position Held: Treasurer

Business Phone: 08 9166 4019

Facsimile:

Mobile Phone: 0428637710

Email: kbletcher@westnet.com.au

Organisation Business Details:

Does your organisation have an ABN?

Yes

☐

No

☒

ABN:

Is your organisation registered for GST?

Yes

☐

No

☒

* Note, in order to be eligible for funding you must attach a copy of the Incorporation Certificate. LGA's exempt

Is your organisation not-for-profit?

Yes

☒

No

☐

Is your organisation incorporated?

Yes

☒

No

☐

Incorporation #: A1011112D *

Bank details:

Bank: Commonwealth

BSB: 066530

A/c: 10012695

Local Government Authority Details:

LGA: Shire of Wyndham East Kimberley

Contact: Nick Allen

Title: Dr ☐ Mr ☒ Mrs ☐ Ms ☐

Position Held: Coordinator of Recreation and Leisure

Business Phone: 08 9168 4100

Facsimile:

Mobile Phone:

Email: Nick.Allen@swek.wa.gov.au

PROJECT DETAILS

Project Title (brief and specific): Kununurra Multi-Sport Storage Shed

Project Description:

This project involves 8 Kununurra sporting clubs banding together to address a common need—lack of facilities to store and keep sporting equipment safe.

One large shed would be built (big rectangle, see attachment A) and each club would have their own lockable section with power and a shared water point outside.

How did you establish a need for your project?

The reason for needing a storage shed are:

- sporting equipment is currently been stored at various club member houses (filling up there sheds)
- equipment is not been looked after (left in rain)
- equipment been stolen (need somewhere for safe keeping)
- there are boxes and boxes of meeting minutes dating back to the 1980's in club member houses (weather proof cabinet in new shed will be great for all of these) and
- annoyance of having club members going through shed to pick up equipment because you are out of town (need a central location for community sporting equipment).

What alternatives were considered and why were they rejected (e.g cost, suitability, feasibility)?

No other alternatives have been tabled, basically if a shed is not built then the status quo remains and expensive sporting equipment is damaged/lost, club member frustrations continue and sport and the community are no better for it.

Have the full lifecycle costs of the project been considered and can you afford the ongoing costs of managing, maintaining and replacing the facility? Will a specific asset replacement fund be created?

We are proposing to build a shed (concrete floor and steel frame), there is not expected to be any unmanageable full life cycle costs. A MoU has been drafted regarding ongoing management, maintenance, insurance etc. See attachment... for copy of MoU

Project location: Ord River Sports Club Inc

Land ownership: Who owns the land on which your facility will be located? Shire of Wyndham East
Kimberley
Lease Expiry (if applicable): NA

Planning approvals

If no, provide the date it will be applied for:

Where applicable, has planning permission been granted? (LGA)

Yes ☐ No ☒ 1/12/2018

Aboriginal Heritage Act?

Yes ☐ No ☐ NA

Department of Biodiversity, Conservation and Attractions? (Environmental, Swan River)

Yes ☐ No ☐ NA

Native Vegetation Clearing Permit?

Yes ☐ No ☐ NA

Please list any other approvals that are required?

Yes ☐ No ☒ 1/12/2018

Building permit

How will your project increase physical activity?

This project will have a massive increase regarding physical activity. Currently, each club has a few members who carry the club along. New and potential committee members are often frightened off when they see what is required to make a game of sport happen.

Example of frustrations (getting ready for a game of cricket): *Grab the stumps from Tom's house, score books from Vicki's, boundary rope from Mick's and equipment from Jane's—it is simply a headache.*

If we could minimise these game day hassles we may encourage more committee members and lighten the load on current members, giving them more time to organise extra sporting events – there is plenty more sporting events that could be held, we just need the legs on the ground to do it.

Do you share your facility with other groups? Yes ☒ No ☐ If so, who:

- Mens Cricket (50 players)
- Womens Cricket (12 players)
- Junior Cricket (31 players)
- Rugby League (32 players)
- Junior Rugby League (28 players)
- Aus Kick (100 players) (see attached letter of support)
- Junior AFL (100 players) (see attached letter of support)
- T-ball (100 players) and (see attached letter of support)
- Touch Football (108 players)

List the main sport and recreation activities (maximum of 3) which will benefit from your proposal. Please indicate the approximate % usage of the facility (or part of the facility relating to this proposal).

| Sport/community organisation | % use of the facility | Hours per week |
|------------------------------|-----------------------|----------------|
| Cricket | 25 | 2 |
| Rugby League | 25 | 2 |
| AFL | 25 | 2 |

Activity/sport membership numbers over the past three years relevant to your project. For example, if a bowls project, golf members not relevant; social membership numbers not applicable.

Note: if membership is not applicable, ie recreation facility or aquatic centre, enter the number of users of the facility.

| | | | | | |
|---------|---------|---------|---------|---------|-----|
| 2015/16 | unknown | 2016/17 | unknown | 2017/18 | 561 |
|---------|---------|---------|---------|---------|-----|

State Sporting Associations are involved in the assessment of applications and may be able to provide valuable information when planning your project, particularly in relation to technical design issues. They should be consulted as part of the application process. A complete list of State Sporting Associations and their contact details are available on the department's website: <http://www.dsr.wa.gov.au/contact-us/find-a-sport-or-recreation-association>

What is the name of the State Sporting Association for your activity/sport?

West Australian Cricket Association

Have you discussed your project with your State Sporting Association? Yes ☒ No ☐

Contact Name: Andrew Hayes (0411056573)

Date of contact: 25 July 2018

PROJECT DELIVERY

Please indicate key milestones of your project. The key milestones need to be realistic and demonstrate that the project can be delivered in the timeframe.

| Task | Date |
|---|-----------------|
| Attainment of Council approvals | 1 December 2018 |
| Preparation of tender/quotes for the major works contract | Completed |
| Issuing of tender for major works | 2 December 2018 |
| Signing of major works contract | 2 December 2018 |
| Site works commence | 10 January 2019 |
| Construction of project starts | 10 January 2019 |
| Project 50% complete | 31 January 2019 |
| Project Completed | 1 March 2019 |
| Project hand over and acquittal | 1 April 2019 |

Are there any operational constraints that would impact on the construction phase of your project? (such as your sporting season, major annual event or inclement weather) – provide details. Projects that are delayed due to undeclared known constraints are not eligible for a deferral.

Not having monies to make happen.

GST

Grant payments are payable to the applicant/grantee only. This may have taxation implications for grantees. If grantees wish specific advice relating to their grant, this can be obtained from the Australian Taxation Office (ATO). Please note depending upon the value of the project and/or grant, the ATO may require an organisation be registered for GST. If the applicant is registered for GST, the grant is grossed up with the GST amount.

PRIVACY STATEMENT AND STATEMENT OF DISCLOSURE

The Organisation acknowledges and agrees that this Application and information regarding it is subject to the *Freedom of Information Act 1992* and that the Grantor may publicly disclose information in relation to this Application, including its terms and the details of the Organisation.

Any information provided by you to DLGSC can be accessed by you during standard office hours and updated by writing to DLGSC or calling (08) 9492 9700. All information provided on this form and gathered throughout the assessment process will be stored on a database that will only be accessed by authorised departmental personnel and is subject to privacy restrictions.

DLGSC may wish to provide certain information to the media for promotional purposes. The information will only include the applicant's club name, sport, location, grant purpose and grant amount.

APPLICANT'S CERTIFICATION

I certify that the information supplied is to the best of my knowledge, true and correct.

Name: Matthew Fletcher

Position Held: Treasurer

Signature: 

Date: 28 July 2018

LODGEMENT OF YOUR APPLICATION

- Applications including all attachments are to be received electronically and officially submitted to csrff@dlgsc.wa.gov.au by the cut off date. A hard copy can also be provided and should be clipped at the top left-hand corner, please do not bind.
- It is recommended that you **retain your completed application form**, including attachments for your own records and future audit purposes.
- All **attachments** and supporting documentation (see next section) should be **clearly named and identified** and submitted with the application form.
- **Applications must be submitted to your Local Government Authority** by the Local Government's advertised cut-off date to ensure inclusion at the relevant Council Meeting.

The following documentation must be included with your application. Applicants may wish to supply additional RELEVANT information.

Grants up to \$66,666:

- ☐ **Application form.**
- ☐ **Incorporation Certificate.**
- ☐ **Two written quotes.**
- ☐ If your project involves the upgrade of an existing facility, include **photograph/s** of this facility.
- ☐ **Locality map, site map and building plans** (in relevant constructions projects), including where the proposed facility is located in relation to other sport and recreation infrastructure.
- ☐ **Income and expenditure statements** for the current and next financial years. (LGAs exempted).
- ☐ **Written confirmation of financial commitments** from other sources including copies of **council minutes**. (If a club is contributing financially then evidence of their cash at hand must be provided).
- ☐ For resurfacing projects, a written guarantee from the supplier of the product that clearly identifies the product's life expectancy.
- ☐ **Itemised project cost for components** and identified on the relevant quote for each (including cost escalation).
- ☐ For floodlighting projects, a **lighting plan** must be supplied showing lux, configuration and sufficient power supply

Your application will be considered not eligible if:

- You have not discussed your project with the Department of Local Government, Sport and Cultural Industries and your State Sporting Association.
- You do not meet the eligibility criteria for the grant category to which you are applying.
- You have not included with your application all the relevant required supporting documentation. **There is no onus on Department staff to pursue missing documentation.**
- Applicants/projects that have received a CSRFF grant in the past and have not satisfactorily acquitted that grant. In some cases this may apply to localities where other significant projects have not been progressed or have not completed a previous project in accordance with the conditions of the grant provided. An assessment will be made in November and if no physical progress has occurred, new applications may not be recommended.
- It is not on the correct application form.
- The project for which application is made is specifically excluded from receiving CSRFF support.

DEVELOPMENT BONUS APPLICANTS ONLY

If you applied for a CSRFF grant for more than one third of the cost of the project, please provide evidence of meeting at least one of the following criteria.

You MUST contact your local DLGSC office to determine eligibility before applying.

| Category | | Details |
|---------------------------|--|--|
| Geographical location | <input checked="" type="checkbox"/> Regional/remote location | Kununurra, East Kimberley |
| | <input type="checkbox"/> Growth local government | |
| Co-location | <input checked="" type="checkbox"/> New | Numerous sporting groups working together |
| | <input type="checkbox"/> Existing | |
| Sustainability initiative | <input type="checkbox"/> Water saving | |
| | <input type="checkbox"/> Energy reduction | |
| | <input type="checkbox"/> Other | |
| Increased participation | <input checked="" type="checkbox"/> New participants | A storage shed will make life so much easier for volunteers, reducing their time managing equipment and enabling them to participate in and encourage others to play more sport. |
| | <input checked="" type="checkbox"/> Existing participants – higher level | |
| | <input type="checkbox"/> Special interest | |
| | <input type="checkbox"/> Other | |

ESTIMATED EXPENDITURE

PROJECT BUDGET

Please itemise the components of your project in the table below, indicating their cost and which quote or part of quote was used to estimate this. Quantity Surveyor costs will be accepted however the responsibility lies with the applicant to ensure the validity of the information. A contingency allowance is considered an acceptable component. **PLEASE ITEMISE BY COMPONENT (e.g changerooms, storage, kitchen) rather than materials (electrician, plumber, finishings).**

| Project Description (detailed breakdown of project to be supplied) | \$ Cost ex GST | \$ Cost inc GST | Quote Used (list company name and quote no) |
|--|----------------|-----------------|---|
| Electrical Works (supply power to shed, 8 LED baton lights and 5 double power points) | 6,250 | 6,875 | Jolly Electrics |
| Plumber (supply water to shed (one communal tap outside), mark out underground pipes to ensure they are not damaged during building) | 4,000 | 4,400 | Ord Plumbing and Gas (quote increased by \$700 to accommodate for extra plumbing required on wash down bay. |
| Concreting (for 160m2 pad) | 21,005 | 23,105.50 | Guymer Concreting |
| Builder (see attached quote for specifications) | 60,545 | 66,599.50 | Bulls Contracting |
| Surveying | 2272.73 | 2,500 | Estimate in discussion with Sharon McLachlan (SWEK) |
| Shed drawings | 4,090.91 | 4,500 | Estimate in discussion with Sharon McLachlan (SWEK) |
| X2 Signs acknowledging supporters | 1,818.18 | 2,000 | Estimate |
| Spray Paint for local youth group to paint shed | 1,818.18 | 2,000 | Estimate |
| Building fees | 1363.64 | 1,500 | Estimation in discussion with Sharon McLachlan (SWEK) |
| | | | |
| Donated materials (Please provide cost breakdown) | 0 | 0 | |
| Volunteer labour (Please provide cost breakdown) | 0 | 0 | |
| Sub Total | 103,163.64 | 113,480 | |
| Cost escalation | 15,474.54 | 17,022 | 15% of budget |
| a) Total project expenditure | 118,638.18 | 130,502 | |

- At least **two written quotes** are required for each component.
- If your project is a floodlighting installation or upgrades, please ensure that the power supply is sufficient and no upgrade will be required. If upgrade is required and not budgeted for, the grant will immediately be withdrawn. A **lighting plan** must be supplied showing lux and configuration.
- Projects that do not meet **Australian Standards** are ineligible for funding.

PROJECT FUNDING

| Source of funding | \$Amount ex GST | \$ Amount inc GST | | Funding confirmed Y / N | Comments to support claim (please attach relevant support) | | | |
|--|--------------------|----------------------|---|----------------------------|---|--|--|--|
| Local government | 30,257.13 | 33,282.84 | LGA cash and in-kind | N | | | | |
| Applicant cash | 29,061.96 | 31,968 | Organisation's cash | Y | | | | |
| Volunteer labour | 0 | 0 | Cannot exceed applicant cash and LGA contribution – max \$50,000 | | | | | |
| Donated materials | 0 | 0 | Cannot exceed applicant cash and LGA contribution | | | | | |
| Other State Government funding | 0 | 0 | | | | | | |
| Federal Government funding | 0 | 0 | | | | | | |
| Other funding – to be listed | 0 | 0 | Loans, sponsorship etc | | | | | |
| CSRFF request (No Development Bonus) | 0 | 0 | up to 1/3 project cost | N | | | | |
| or CSRFF request (Development Bonus) | 59,319.09 | 65,251 | Up to 1/2 project cost | N | | | | |
| b) Total project funding | 118,638.09 | 130,502 | <i>This should equal project expenditure as listed on the previous page</i> | | | | | |
| REQUIRED: If the funding approved is less than funding requested for this project, or the project is more expensive than indicated, where would the extra funds be sourced from? Is this funding confirmed? If the project scope would be reduced, which components would be revisited? | | | | | | | | |
| Funding is confirmed, there is a 15% cost escalation buffer built into budget for cost blow outs. If funding approved is less than funding requested, we would like to reserve the right to revisit application. | | | | | | | | |

GST

Grant payments are payable to the applicant/grantee only. This may have taxation implications for grantees. If grantees wish specific advice relating to their grant, this can be obtained from the Australian Taxation Office (ATO). Please note depending upon the value of the project and/or grant, the ATO may require an organisation be registered for GST. If the applicant is registered for GST, the grant is grossed up with the GST amount.

PROJECT ASSESSMENT SHEET

This page is for the use of the relevant Local Government Authority to be used for both community and LGA projects. Please **attach copies of council minutes** relevant to the project approval.

| |
|--|
| Name of Local Government Authority: |
| Name of Applicant: |

Note: The applicant's name cannot be changed once the application is lodged at DLGSC.

Section A

The CSRFF principles have been considered and the following assessment is provided:
(Please include below your assessment of how the applicant has addressed the following criteria)

All applications

| | Satisfactory | Unsatisfactory | Not relevant |
|---|--------------------------|--------------------------|--------------------------|
| Project justification | <input type="checkbox"/> | <input type="checkbox"/> | <input type="checkbox"/> |
| Planned approach | <input type="checkbox"/> | <input type="checkbox"/> | <input type="checkbox"/> |
| Community input | <input type="checkbox"/> | <input type="checkbox"/> | <input type="checkbox"/> |
| Management planning | <input type="checkbox"/> | <input type="checkbox"/> | <input type="checkbox"/> |
| Access and opportunity | <input type="checkbox"/> | <input type="checkbox"/> | <input type="checkbox"/> |
| Design | <input type="checkbox"/> | <input type="checkbox"/> | <input type="checkbox"/> |
| Financial viability | <input type="checkbox"/> | <input type="checkbox"/> | <input type="checkbox"/> |
| Co-ordination | <input type="checkbox"/> | <input type="checkbox"/> | <input type="checkbox"/> |
| Potential to increase Physical activity | <input type="checkbox"/> | <input type="checkbox"/> | <input type="checkbox"/> |
| Sustainability | <input type="checkbox"/> | <input type="checkbox"/> | <input type="checkbox"/> |

Section B

Priority ranking of no of applications received of applications received

Is this project consistent with the ☐ Local Plan ☐ Regional Plan

Have all planning and building approvals been given for this project? ☐ Yes ☐ No

If no, what approvals are still outstanding?

Project Rating (Please tick the most appropriate box to describe the project)

- | | | |
|---|--|--------------------------|
| A | Well planned and needed by municipality | <input type="checkbox"/> |
| B | Well planned and needed by applicant | <input type="checkbox"/> |
| C | Needed by municipality, more planning required | <input type="checkbox"/> |
| D | Needed by applicant, more planning required | <input type="checkbox"/> |
| E | Idea has merit, more planning work needed | <input type="checkbox"/> |
| F | Not recommended | <input type="checkbox"/> |

Please complete the questions attached. This assessment is an important part of the CSRFF process and your answers to these questions assist the committee make their recommendations, even if you are the applicant. Please provide a summary of any attachments in your assessment, rather than referring to attachments or external documents such as Council Minutes.

1. Please confirm your contribution to the project, whether it has been formally approved (including financial year for which it is approved) and any conditions on the funding. If no funding has been provided, why not?
2. A) *If a community group application:* Do you believe the project is financially viable, including the applicant's ability to provide upfront contributions, ongoing payments and contributions to an asset replacement fund. Does council commit to underwriting any shortfalls as the ultimate asset owner?

B) *If a council application:* Is Council fully aware of the ongoing cost of operating and maintaining this facility and does your organisation have the capacity to service it into the future? How are the user groups contributing to the ongoing cost of operating the facility?
3. Please provide any additional comments regarding this applications merit against the assessment criteria to support your project rating and ranking.

Signed

Position

Date

Applications for CSRFF funding must be submitted to your Department of Local Government, Sport and Cultural Industries office by **4pm on 31 August 2018**. Late applications cannot be accepted in any circumstances.

DLGSC OFFICES

PERTH OFFICE

246 Vincent Street
Leederville WA 6007
PO Box 329
Leederville WA 6903
Tel: (08) 9492 9700
Fax: (08) 9492 9711

PEEL

Suite 94
16 Dolphin Drive
PO Box 1445
Mandurah WA 6210
Tel: (08) 9550 3100
Fax: (08) 9550 3199

PILBARA

Karratha Leisureplex
Dampier Hwy, Karratha
PO Box 941
Karratha WA 6714
Tel: (08) 9182 2100
Fax: (08) 9182 2199

SOUTH WEST

80A Blair Street
PO Box 2662
Bunbury WA 6230
Tel: (08) 9792 6900
Fax: (08) 9792 6999

GREAT SOUTHERN

22 Collie Street
Albany WA 6330
Tel: (08) 9892 0100
Fax: (08) 9892 0199

GASCOYNE

4 Francis Street
PO Box 140
Carnarvon WA 6701
Tel: (08) 9941 0900
Fax: (08) 9941 0999

GOLDFIELDS

1/349 Hannan Street
PO Box 1036
Kalgoorlie WA 6430
Tel: (08) 9022 5800
Fax: (08) 9022 5899

KIMBERLEY – Broome

Unit 2, 23 Coghlan Street
PO Box 1476
Broome WA 6725
Telephone (08) 9195 5750
Facsimile (08) 9166 4999
Mobile 0438 916 185

WHEATBELT - NORTHAM

298 Fitzgerald Street
PO Box 55
Northam WA 6401
Tel: (08) 9690 2400
Fax: (08) 9690 2499

WHEATBELT – NARROGIN

Government Offices
Level 2, 11-13 Park Street Narrogin
WA 6312
Telephone 0429 881 369
Facsimile (08) 9881 3363

MID-WEST

Level 1, 268-270
Foreshore Drive
PO Box 135
Geraldton WA 6531
Tel: (08) 9956 2100
Fax: (08) 9956 2199



Department of Consumer & Employment Protection
Government of Western Australia

WESTERN AUSTRALIA
Associations Incorporation Act 1987
(Section 9(1))

Registered No: A1011112D

Certificate of Incorporation

This is to certify that

EAST KIMBERLEY CRICKET ASSOCIATION INC.

was on the thirty-first day of July 2003
incorporated under the
Associations Incorporation Act 1987.

Dated this thirty-first day of July 2003

Commissioner for Fair Trading

CERTIFICATE

Multi Sport Storage Shed (DRAFT)

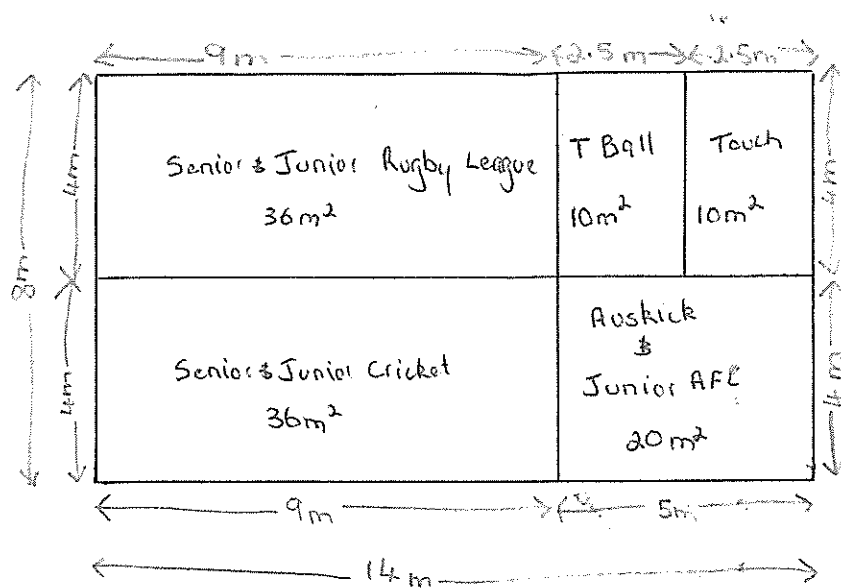

Multi Sport Storage Shed (DRAFT)

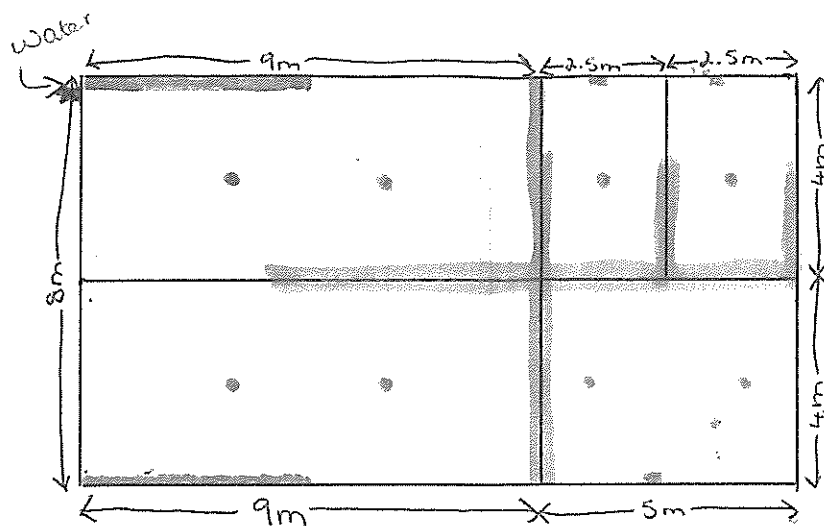

- lights
- sliding doors
- swinging doors
- shelving
- water

Multi sport storage shed (DRAFT)

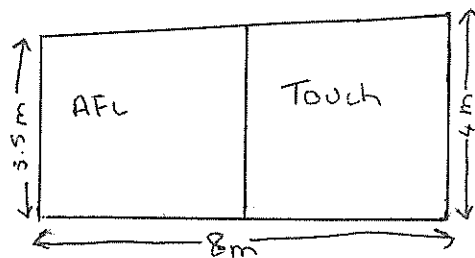

Side on view
of shed looking
at side, where
Touch jocky and
AFL are.

* Ceiling to be insulated to protect
equipment from hot roof

ATTACHMENT A

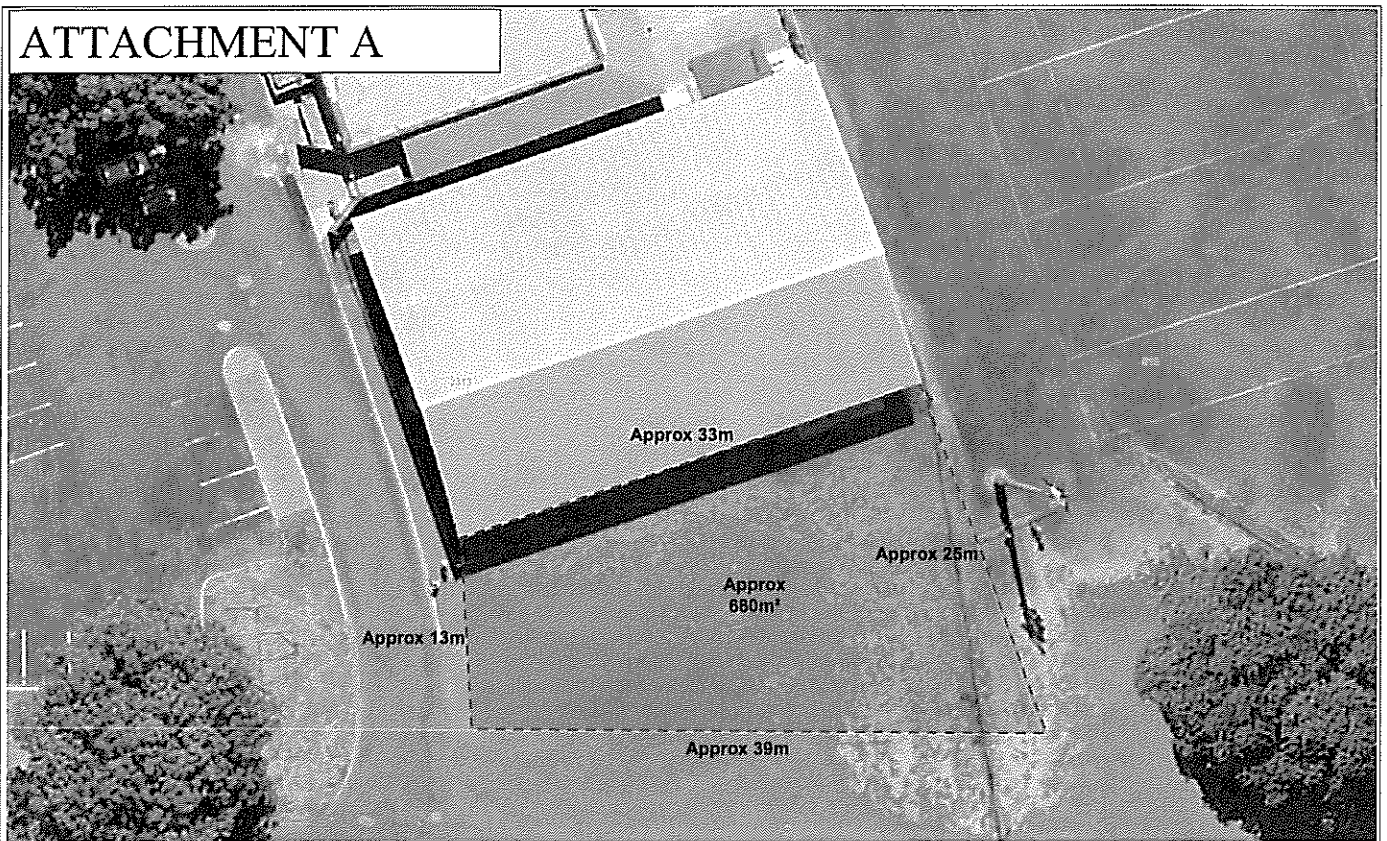

The Shire of Wyndham East Kimberley does not warrant the accuracy of information in this publication and any person using or relying upon such information does so on the basis that DMS shall bear no responsibility or liability whatsoever for any errors, faults, defects or omissions in the information.

Approximate area

29/03/2018

1:250



Kalyn and Matt Fletcher

From: Ord Plumbing and Gas <ordplumbing@westnet.com.au>
Sent: Sunday, 15 April 2018 5:50 PM
To: kbletcher@westnet.com.au
Subject: Water supply to the proposed shed @ ORSC

Hi Matt,

As discussed on Saturday I think the figure of \$2000+gst would be for the installation of water too the shed and to find and plot the existing reticulation a further \$1000+GST I hope this is what you are after mate

Cheers

Mark Davey

Licensed Plumber



PO Box 575 Kununurra WA 6743

Mobile: 0404 765 853



QUOTE

Matt Fletcher

Date
18 Apr 2018

Expiry
30 May 2018

Quote Number
QU-0030

Reference
Sporties Shed

ABN
17 102 406 991

PO Box 2591, Kununurra
WA 6743

Office@
bullscontracting.com.au
0447 192 187

| Item | Description | Quantity | Unit Price | Amount AUD |
|--------------------|---|----------|------------|------------|
| Carpentry Services | Sporties Shed: Supply & Installation of shed structure | 1.00 | 36,380.00 | 36,380.00 |
| Carpentry Services | Supply & installation of shelving | 1.00 | 5,000.00 | 5,000.00 |
| Carpentry Services | Supply & Installation of 50x50 mesh around external structure for security | 1.00 | 2,460.00 | 2,460.00 |
| Carpentry Services | Supply & install steel security doors to all openings | 1.00 | 7,990.00 | 7,990.00 |
| Carpentry Services | All doors and security doors to be keyed for each compartment (rugby, AFL, cricket etc.), one master key to be supplied for all locks | 1.00 | 760.00 | 760.00 |
| Carpentry Services | Supply & install internal walls to plan | 1.00 | 6,450.00 | 6,450.00 |
| Carpentry Services | Supply & install insulbreak (insulation) to ceiling and walls as requested | 1.00 | 1,505.00 | 1,505.00 |
| Carpentry Services | * Bulls Contracting will work with Guymer concreting to fit runners for sliding doors (included in price) | | | |
| | * Discount or donation offered if Bulls Contracting sign to be placed on structure | | | |
| | * Security screws to external wall cladding included in price as discussed | | | |
| | * Bulls Contracting can offer building licence and engineered drawings upon request. This would be for an extra cost, approx. \$4,800+gst | | | |
| Subtotal | | | | 60,545.00 |
| TOTAL GST 10% | | | | 6,054.50 |

Guymer **Concreting and Construction**

ACN 619715570
 ABN 36619715570
 QBSA Licence 1152350
 PO Box 638, Kununurra WA 6743

Lee 0428137753
 Kate 0438310799
guymerconcreting@hotmail.com

13th April 2018

Quote valid for 30 day

Quote - Concrete shed floor At Sporties, Kununurra for Combined Sports Clubs

Quote Includes -
 Earthworks (level earth pad)
 Formwork & installation of formwork
 Preparation of reinforcement
 Place & finish of Concrete
 Plant hire
 Materials & their delivery

| | | | |
|---------------------|--|----|-----------|
| Labour/Plant Hire - | Earthworks labour (level pad 160m2) | \$ | 700.00 |
| | Bobcat/excavator/tipper | \$ | 1 000.00 |
| | Profiling/set-out | \$ | 420.00 |
| | Concrete - form, prep, place & finish (shed floor) | \$ | 4 750.00 |
| | Concrete - form, prep, place & finish (mowing strip) | \$ | 2 420.00 |
| | Bollards - excavate hole, place & finish | \$ | 1 120.00 |
| | Sub-total | \$ | 10 410.00 |
| | GST | \$ | 1 041.00 |
| | TOTAL | \$ | 11 451.00 |

| | | | | |
|-------------|-----------------------------|-----------|----|-----------|
| Materials - | N25 Concrete (floor) | 15m3 | \$ | 5 400.00 |
| | N25 Concrete (mowing strip) | 1.5m3 | \$ | 540.00 |
| | N20 Concrete (bollards) | 1.5m3 | \$ | 525.00 |
| | SL72 mesh | 10 sheets | \$ | 900.00 |
| | SL72 mesh | 2 sheets | \$ | 180.00 |
| | 311TM (trench mesh) | 8 lengths | \$ | 320.00 |
| | Plastic | 1 roll | \$ | 180.00 |
| | 50/65 chairs | 4 bags | \$ | 160.00 |
| | Wire | 1 roll | \$ | 20.00 |
| | Tape | 1 roll | \$ | 10.00 |
| | Ableflex | 2 rolls | \$ | 120.00 |
| | Bollards | 8 of | \$ | 1 040.00 |
| | Pindan sand | 32m3 | \$ | 1 200.00 |
| | Sub-total | | \$ | 10 595.00 |
| | GST | | \$ | 1 059.50 |
| | TOTAL | | \$ | 11 654.50 |

| | |
|----------------------------------|--------------|
| Labour/Plant Hire - Floor (inc.) | \$ 11 451.00 |
| Materials - Floor (inc.) | \$ 11 654.50 |

TOTAL (inc.) \$ 23 105.50

We appreciate the opportunity to provide you with a quote for this project.
 Quote is calculated on 112m2, 100mm thick slab with reinforcement and thickened edges with trench mesh.
 Earth pad made from pindan sand is calculated on being 16m x 10m x 0.2m.
 If you have any questions, please don't hesitate to call.

Lee Guymer

PO Box 638 Kununurra, WA 6743
guymerconcreting@hotmail.com
 Lee 0428137753 Kate 0438310799

Guymner
Concreting and Construction

ACN 619715570
ABN 36619715570
QBSA Licence 1152350
PO Box 638, Kununurra WA 6743

Lee 0428137753
Kate 0438310799
guymnerconcreting@hotmail.com

0428 137 753

PO Box 638 Kununurra, WA 6743
guymnerconcreting@hotmail.com
Lee 0428137753 Kate 0438310799

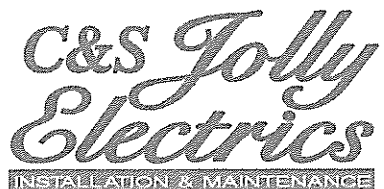

0429 115 346 EC8587

Lot 147 Whimbrel Rd, Kununurra
WA

PH: 08 91691608
FAX: 08 91691609
MOB: 042 911 5346
sam@jollyelectrics.com.au
ABN: 28 454 701 259

Quotation # 5054

Accounts Payable
Matt Fletcher
Matt & Kalyn Fletcher
PO Box 700
Kununurra, WA 6743

WORK TO BE CARRIED OUT AT: Matt & Kalyn Fletcher, PO Box 700,
Kununurra, WA 6743

| | | |
|-----------------------|----------------|----------------|
| DATE: 12th April 2018 | CUST ORDER NO: | QUOTE NO: 5054 |
|-----------------------|----------------|----------------|

DESCRIPTION

Quote to supply and install electrical wiring and fittings to new multi sport storage shed at the Sporties.
Includes Rcd protected supply to shed, 8x LED baton lights on push button timers and 5x double power points.
Termination, testing and commissioning.

Excludes trenching and backfilling.

| | | |
|--|-------------|------------|
| | SUBTOTAL | \$6,250.00 |
| | GST | \$625.00 |
| | TOTAL QUOTE | \$6,875.00 |

General Exclusions:

- ❖ Scaffolding, rigging, machinery hire, and any concrete and civil works.

❖ Alterations to quantities of drawings, damage to unknown services, principle supplied equipment and repairs to principle supplied equipment, and communication transmissions.

Memorandum of Understanding

Between

Users of Multi Sport Storage Shed (located at the Ord River Sports Club Inc)

and

Ord River Sports Club Inc

This Memorandum of Understanding (MOU) sets the terms and understanding between **users of the Multi Sport Storage Shed** and **Ord River Sports Club Inc** to formalize management of this facility into the future including: fees, unit tenancy, maintenance and insurance.

Background

Funding was secured in early 2018 by a combined effort of Kununurra sporting groups to build a 'multi-sport storage shed' on land owned by the Shire of Wyndham East Kimberley and leased by the Ord River Sports Club Inc.

The Ord River Sports Club gratefully made land available close to Kununurra Town Oval where users of the shed play their sport. It was desirable to work with the Ord River Sports Club to minimise utility and insurance costs and support the community owned/managed club. It was also desirable for the Ord River Sports Club Inc to welcome the various sporting groups—supporting and encouraging sport in Kununurra.

Users of the Multi Sport storage shed are:

- Mens Cricket
- Womens Cricket
- Junior Cricket
- Rugby League
- Junior Rugby League
- Aus Kick
- Junior AFL
- T-ball and
- Touch Football

Purpose

This MOU formally outlines what is expected of 'users of the Multi Sport Storage Shed' and the 'Ord River Sports Club Inc' to ensure successful management of this asset into the future.

The above goals will be accomplished by undertaking the following activities:

Fees:

- Fees paid to Ord River Sports Club Inc by Cricket and Rugby League will be \$250/year
- Fees paid by other users will be \$100/year
- Fees will be capped for five years and then reviewed
- Fees are to be paid at the start of each financial year in advance

Unit Tenancy:

- The shed is owned by each respective sporting group that was part of the funding application to SWEK and DSR
- The Ord River Sports Club Inc own the land on which the shed is built

Shed Maintenance:

- Each respective sporting club is responsible for maintaining their unit. For example, changing lights, fixing doors and replacing faulty power points

Insurance:

- The shed structure will be covered under Ord River Sports Club Inc insurance
- Contents of the shed will not be insured under Ord River Sports Club Inc insurance and each respective club will need to organise their own insurance through their respective state sporting authority

Reporting

After six months from the signing of this letter a representative from each respective sporting club using the facility and President of the Ord River Sports Club Inc will meet and evaluate the management of this facility.

Duration

This MOU is at-will and may be modified by mutual consent of authorized officials from Mens Cricket, Womens Cricket, Junior Cricket, Rugby League, Junior Rugby League, Aus Kick, Junior AFL, T-ball and Touch Football and the Ord River Sports Club (partners). This MOU shall become effective upon signature by the authorized officials from the above listed partners and will remain in effect until modified or terminated by any one of the partners by mutual consent.

Contact Information

Matthew Fletcher
East Kimberley Cricket Association
Treasurer
PO Box 1656, Kununurra WA 6743
0428637710

kbfletcher@westnet.com.au

Corrie Rasmussen
Ord River Sports Club Inc
President
PO Box 54, Kununurra WA 6743
08 9169 1778
ordriversportsclub@bigpond.com

 Date: 27/7/2018

Matthew Fletcher, East Kimberley Cricket Association, Treasurer

 Date: 27/7/2018

~~Corrie~~ Rasmussen, Ord River Sports Club Inc, President
CORIE CR

Kalyn and Matt Fletcher

From: Banjo McAuliffe <banjo@argyleengineering.com.au>
Sent: Tuesday, 17 April 2018 5:59 AM
To: 'Kalyn and Matt Fletcher'
Subject: Storage Shed Support

Matt,

It is a pleasure, that as President of the Rotary Club of Kununurra, I can tell you that the board has agreed to support "in principle", The East Kimberley Cricket Association Inc. with a pledge to donate \$10,000 to be put towards a multi-sport storage shed.

It is understood that this money will support those smaller sporting clubs, particularly the youth clubs, with their co-contribution. In return Rotary Kununurra would like some permanent acknowledgement that reflects their level of contribution. As this is at very early stages, as part of the planning, provision should be made to future proof this building. I.e. can it be designed to allow future extensions, what would be the tenure, and who or how will it be managed 10 – 20 years from now. I am sure these are all points that will be considered in due course but we believe important to mention.

This project meets our Club Guidelines such that, it is for the benefit of the local community and a number of groups benefit with the greatest benefactors being youth.

As this project proceeds I will remain the Rotary point of contact for the foreseeable future, (My tenure of Presidency will end June 30 2018), we hope this will keep the momentum going.

The East Kimberley Cricket Association will advise us when funds are required.

You and your association need to be commended on undertaking this project for the sporting community and youth of Kununurra.

Regards,

Banjo

For and on behalf of the Rotary Club of Kununurra
President 2017/2018

J. McAuliffe

Managing Director
0448 774 135



1130 Dianella Way Kununurra
PO Box 837 Kununurra WA 6743
Ph: (08) 9169 1097 Fax: (08) 9169 1086
www.argyleengineering.com.au



J. McAuliffe

Managing Director
0448 774 135



**ORD RIVER TEEBALL
CLUB INCORPORATED**

Registered No: A1003939X

Po Box 1577
KUNUNURRA WA 6743
knxteeball@outlook.com

9th May 2018

To Whom It May Concern

I am writing to show my support of the East Kimberley Cricket Associations request for funding to build a Mulit Sports Storage Shed.

I believe their request is important to protect each clubs expensive sporting equipment securely.

Sincerely

Julie Brown

President

Ord River Tee Ball Association



Ord River Sports Club Inc
77 Chestnut Avenue, Kununurra, WA, 6743
PO Box 54, Kununurra, WA, 6743
Ph # 08 9169 1778 Fax # 08 9169 2743
ordriversportsclub@bigpond.com

21st May 2018

Re: Multiple Use Secure Storage Shed

To whom it may concern,

We are pleased to provide a letter of support for a multi-use storage shed.

Ord River Sports Club Inc has been the hub for a large array of sports played up here in the East Kimberley region, including Cricket, Rugby League (Junior and Senior), Touch Football, Softball, Auskick, Little Athletics, AFL and much more.

There is a high need for a secure shed to house the various club's equipment.

The current sports club storage space is inadequate with the expanding and growing interest in both grass roots sports and other sporting groups building in numbers.

Ord River Sports Club Inc, sees a huge potential in the Storage Shed and support this project, we have an area of land suitable to develop into the shed.

We believe that this shed is vital for the future of sports.

Should you require any further information from our club, please feel free to contact me direct on 0459 023 202.

Kind regards

Corie Rasmussen

President – Ord River Sports Club Inc

Kununurra Junior Football Association Inc

PO Box 608 Kununurra WA 6743

knxjuniorfootball@outlook.com

ABN: 48 640 050 080 Registered No: A1006003Y

10th May 2018

To Whom It May Concern

We would like to show our support of the East Kimberley Cricket Associations request for funding to build a Mulit Sports Storage Shed.

The purchase of this facility will allow us to securely store our equipment and uniforms onsite at the oval.

Sincerely

Wally Lovelock

President

Kununurra Junior Football Association

Kununurra Junior Football Association Inc

AUSKICK

PO Box 608 Kununurra WA 6743

knxjuniorfootball@outlook.com

ABN: 48 640 050 080 Registered No: A1006003Y

10th May 2018

To Whom It May Concern

We would like to show our support of the East Kimberley Cricket Associations request for funding to build a much needed Mult Sports Storage Shed.

At present our equipment is passed from one person to the next to look after or find room for, it is not ideal as things go missing or someone forgets to bring them to the game. Our sports rely on our volunteers and I believe this storage shed will help us store the equipment securely and away from the elements.

Sincerely

Libby Fitzpatrick

Auskick Co-ordinator

Kununurra Junior Football Association

Kalyn and Matt Fletcher

From: RB Dessert Seed Co <dessertseed@westnet.com.au>
Sent: Sunday, 27 May 2018 6:38 AM
To: kbletcher@westnet.com.au
Subject: Fwd: Multi Storage Facility

>
> Hi Matt,
>
> Thank you for your letter seeking financial support to build a multi sport storage shed at the Kununurra Town Oval.
>
> We are pleased to offer our support for the project with \$10000.00.
>
> Regards
> Raymond Dessert
> Apex Kununurra
> Vice-President
>
>
>
> RB Dessert Seed Co
> 0417944256
> dessertseed@westnet.com.au
>
>

